



ADAPTING THE REED BARN

The outcomes of Output 4 for the MONUMENT Project “Site adapted to improve the use by PLWD and their informal carers, including improvements to signage.” From the National Trust PP11



Adaptations to the Reed Barn at Peckover House

Introduction

The National Trust has transformed the Reed Barn at Peckover House and Gardens in Wisbech into a safe place where people living with dementia, their families and carers, can share experiences, gain new skills and take a break from caring responsibilities. This new service called Damsons after the fruit grown in the garden at Peckover for years, which provides a sense of belonging and place. The adaptations were made as part of the MONUMENT interreg2seas programme as part of Output 4 “Site adapted to improve the use by PLWD and their informal carers, including improvements to signage.” This report will outline the process and results of this Output and demonstrate the success of adapting sites to make them more dementia friendly.

Executive Summary

The process of adapting the Reed Barn started with the aim to make the site as dementia friendly as possible within the budget and confines of the National Trust legislation. An accessibility audit and ‘walkaround’ provided the plans and the workstream team implemented the changes required. New lighting, more comfortable furniture, a change in layout and improved signage has transformed the Reed Barn into the Odense House service it runs today. The MONUMENT project has breathed new life into the Reed Barn. From the effects of the pandemic, to what it is now has been a testament to the team at Peckover House who have ensured that the Reed Barn is a comfortable, homely and friendly space for people living with dementia and their informal carers.

The Process

The Reed Barn is a Grade II listed building dating to the 17th century and has had many uses over the three centuries. In October 2021 planning started to make adaptations to the Reed Barn for the MONUMENT project. The site was used as a café in its most recent iteration before the COVID-19 pandemic meant the café closed leaving an empty space to be utilised. This was one of the main attractions for having the Odense House based at Peckover House. The picture of the Reed Barn below show the level of use it had had since 2020.



It was decided that the first step to adapting the site would be to evaluate and audit what was then offered by the site. Together with the Regional Operational Risk Business Partner in August 2021 an audit was completed in line with the standard National Trust Accessibility Audit and additional

information provided by the Alzheimer's Society (which the National Trust holds a national partnership with). This highlighted a number of areas which required adaptation. As a follow up a 'walkaround' was completed in October 2021 to assess the dementia friendliness and to make recommendations of changes to be made. The outcomes of this can be found in appendix 1. A number of areas of change were identified as part of this work and were assessed based on their cost-benefit analysis.

The Adaptations

Over the course of 2022 until July, work took place to adapt the site to ensure it was dementia inclusive and incorporated the five values of an Odense House. A tracker was created by the workstream which allowed us to track each of the changes being made to ensure this was completed on time.

	A	B	C	D	E	G	H
	Adaptation	Change	Owner	Quote (if required)	Estimated date of Completion	RAG	
1	Link for reference	Indoor Signage					
2		New Toilet Sign dementia friendly on each cubicle (on outside of door)	polly		06/06/2022		
3		Each toilet must also have an exit sign on the internal side of the door	polly		07/06/2022		
4	Access	Ensure Automatic Doors opens fully	geoff		10/06/2022		
5		Hosting a defib	Ben				
6	Coat hangers	Move pegs closer to the door	Ben				
7	Windows	Cleaned and dusted inside and out	geoff				
8		Asked Red Lion Pub to trim branches close to the windows	Ben				
9	Toilets	Paint of toilets	geoff	£2875 plus va	03/03/2022		
10		Paper Towel Dispensers in each cubicle	Ben		27/05/2022		
11		Grab rails need to be installed where not already	Ben	£59			
12		White toilet seats to be changed to a coloured alternative.	Ben	£101			
13		Soap dispensers to be added to the wall in each cubicle that offers good	Ben				
14	cleaning	deep clean of whole barn	Ben	£685	4-6/07/2022		
15		Signs/ pictures to be added to taps to ensure they can be worked accor	Polly		10/06/2022		
16	Lighting	Arrange Lighting specialist to come and advise and quote for lighting ne	Ben				
17		Lighting changes to be completed	Geoff		17/06/2022		
18	Furniture	See other tab					
19	Gardens	Arrange trimming of potential trip hazards and shadows (where possible)	Jenny		06/07/2022		
20	Kitchen	Service all equipment? get in a usable condition?	Ben ask Natalie Farr				
21	Wifi	Public wifi at the barn	Ben to ask Richard Thom		24/06/2022		
22							
23							
24							

The largest expense was the change to the lighting completed by RedRoc equipping the barn with sophisticated natural and dimmable lightbulbs. This allows the site to choose the lighting needs for each individual zone. For example, the Magic Table 360 from Social Ability requires a lower level of light, but the craft table requires higher levels. The toilets were also repainted to update them and to ensure that they were easy navigable for people living with dementia.

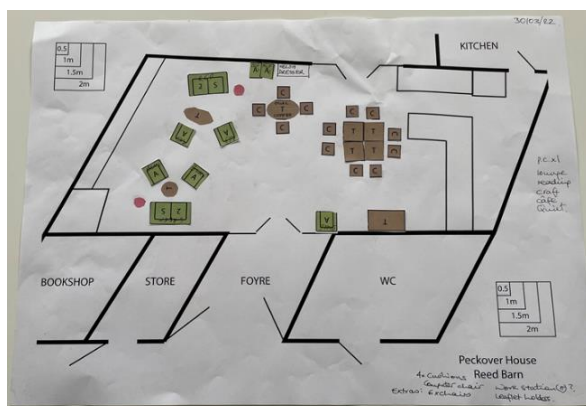

New furniture has been installed in the Reed Barn to create a more comfortable, homely feel, to help people relax and feel able to participate in any activities on offer. A volunteer created a floor plan of the space to allow a testing of different zones within the Reed Barn with new furniture arranged to provide a number of different areas to fit the needs of people living with dementia and their informal carers.

The National Trust has also been working with Social-Ability and has incorporated their Magic Table 360 into the Odense House. The Magic Table was designed to enhance the space by providing another communal zone for people living with dementia and their carers to engage with each other through play.



Signage has been a crucial change to the Reed Barn in allowing to be become more dementia friendly. A chalkboard sign provides a welcoming and familiar welcome to visitors and increased signage within the barn and surrounding area provides a safer space for people living with dementia as demonstrated by the signage to direct people out of the toilet.

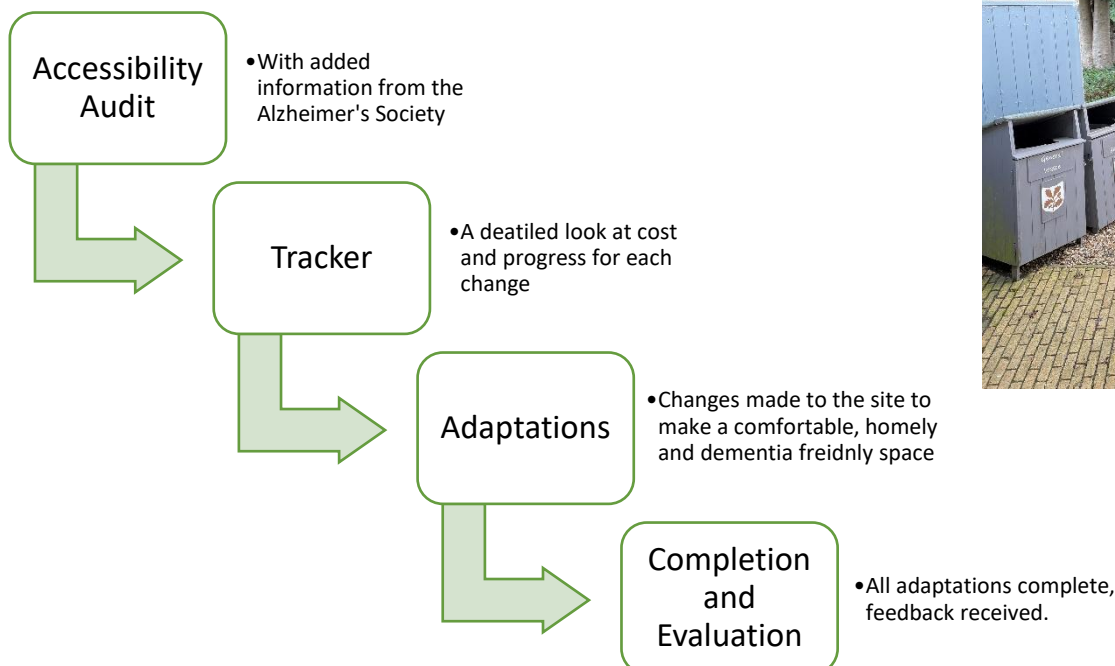

Conclusion



The Reed Barn has seen itself transformed into the cornerstone of dementia care within its local area. Bringing the National Trust into the local community of Wisbech and recognising its past and its ties to the community. The Reed Barn has been developed by the community for the community. The feedback we have received has been excellent.

Appendix 1:

MONUMENT Project
Walk around notes
Wednesday 20th October 2021

Attendees:

Tom Bailey Sarah Dyer
Ben Rickett Geoff Morley
Russell Clement

Notes:

- **Exterior entrances to Peckover House:**

Signage from the front gates of Peckover House is to be changed – directions by foot to the Reed Barn.

New signs positioned – on front railings; on front single gate; on brick wall straight ahead; an A board (to the left) directing round to the right; covering the original sign with directions to the garden; a sign directing through the garden towards the Reed Barn; two or three A boards redirecting people from different areas of the garden; a sign on wall under the main Reed Barn sign; an A board directing towards the barn's entrance door; a large sign on the front of the Reed Barn.

- **Pathways to the Reed Barn:**

The aggregate under foot walking through the gate and towards the garden is in need of being levelled off and made more uniform. **RC** is to discuss the possibility of having a central 'pathway' made of suitable smooth aggregate to prevent trip hazards and to help with directional guidance towards the Reed Barn.

- **Garden:**

Over hanging bushes and tree branches are going to be trimmed to prevent eye level accidents and shadows forming over pathways.

- **Toilets:**

Exit and Entrance signs to be put up on the exterior door entering the toilet area.

New clear dementia-friendly signs (written and icon) need to be put on the front of each cubicle door.

signs need to be put up on the internal side of each of the cubicle doors. Yellow paint to be changed – a suitable colour choice is to be picked to add contrast.

Grab rails to be added in each cubicle and the central toilet area.

White toilet seats to be changed to a coloured alternative.

Paper towels/ containers to be affixed to the walls in each cubicle to replace the hot air dryers (which are going to be turned off).

Soap dispensers to be added to the wall in each cubicle that offers good contrast in colour with clear instructions of usage.

Taps to be changed to some that clearly define Hot and Cold and how they are used. Signs/ pictures to be added if required.

- **Exterior entrance to the Reed Barn:**

GM is to arrange the windows to be cleaned.

- **Reed Barn porchway:**

Electric doors – Require a service and modifications if necessary.

A long, straight ramp is required to enable access in the porch and up into the Reed Barn. Handrails will be required on the ramp too.

The bulbs in the existing wall lights need to be changed to be more subtle and diffused lighting.

- **Reed Barn**

- a. **space**

The space needs clearing – tables, chairs, pictures on walls and other furniture.

Freestanding boards and bookshelves to be removed.

- b. **flooring**

Floors seem to be level and free of trip hazards. Markings (ie maybe tape) should be added to any areas that change level eg at the top of the slope at the entrance to the Reed Barn.

- c. **fixed assets ie walls**

The walls are, generally, fine.

The decorative farm utensils can remain – add interest and topic of conversation.

- d. **Lighting and natural light**

Daylight panels to be costed and fitted. Is it possible to have dimmer switches fitted?

- e. **Acoustics**

Hanging panels
to help with reverberation to be costed and fitted.

f. **Soft furnishings**

National Trust approved chairs to be researched, as well as the Alzheimer's Society recommended too.

Maybe edges of the tables and the chairs will need the addition coloured tape to define their edges. Also, at the base of the table and chair legs.

A defibrillator – to be hosted maybe in the Reed Barn?